

## Liberta Roller Blind Motor

### Fitting Instructions

This procedure can be completed by non-professionals.

#### Fitting the blind:

This procedure for fitting can be completed by non-professionals. No modification of the design or the configuration of the equipment must not be made without consulting with your local distributor.

1. Decide whether you want to fit wall fix or top fix.
2. Check that the blind fits the opening.
3. The motor end will have the bracket with the cross in it.
4. The idle end will have a round hole.
5. Be sure that you have the motor on the correct side according to the order.
6. Position the brackets where you want to fit.
7. Mark through the holes with a pencil.
8. Drill a pilot hole or a hole to take a wall anchor if required.
9. Attach the brackets with 2 screws for each bracket. [Please note that screws and other fixings are not provided.]
10. Take the blind out of all the packaging and insert the pin into the round hole of the idle end bracket.
11. Hook the motor end into the slotted bracket making sure that it is firmly clipped into place.
12. Remove the retaining strip of fabric holding the blind.
13. Blinds will be supplied with the paring and limits already set up.
14. **WARNING:** The motor must be **fully** charged before first use to avoid damage to the battery. To fully charge the motor, plug in the charger and leave for a minimum of 6 hours.

### IMPORTANT SAFETY INSTRUCTIONS

WARNING - FOR PERSONAL SAFETY, IT IS IMPORTANT TO FOLLOW THESE INSTRUCTIONS AT ALL TIMES  
SAVE THESE INSTRUCTIONS

### Operating Instructions

1. Press the buttons on the remote to operate the blind. \*15 Channel Remote Only\* Switch channel using the buttons labelled on the inside page.
2. Do not allow children to play with the remote control of the blind. Keep remote controls away from children.
3. Take appropriate organisational measures for preventing operation of the blind when maintenance, such as window or wall cleaning, is being carried out in the vicinity.

### Maintenance Instructions

#### 1. Recharging the Battery

1.1 When the battery is low, the motor will beep when operated, and needs to be recharged.

1.2 Plug the charging unit into the motor. The charging unit fits a standard UK socket.

1.3 Leave for approximately 6 hours. The light on the charger will turn green when the battery is fully charged. It is important that the battery is fully charged before first use.

#### 2. Caring for your Blind

2.1 Wiping the blind with a soft brush or duster is usually sufficient.

2.2 If necessary, blinds can be wiped clean with a mild detergent and warm water. Leave in the open position to dry.

2.3 Do not make alterations to the blind, motor or handset.

2.4 Frequently examine the installation for signs of wear or damage to cables. Do not use if a repair is necessary.

The sound level emitted by the blind is less than or equal to 70 dB(A).

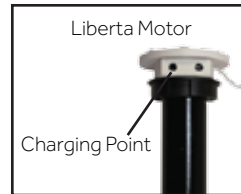

## Liberta Roller Blind Motor

### Programming Instructions

#### 1. Pairing the Handset

1.1 \*15 Channel Handset Only \*Select the channel on the handset that you wish to pair the blind to. [Please note that you cannot pair blinds to Channel 00.]

1.2 Press and hold the programming button on the motor for approximately 4 seconds. The motor should step and beep.

1.3 Press the setup button (labelled as Setup or P2) on the back of the handset twice then the up button. This must be done in a smooth rhythm (allow 1 second between pressing each button). The motor should beep and step to confirm that the pairing is complete.

1.4 Check that the motor is running in the correct direction. (I.e. Press the up button and the blind goes up). If required, refer to section 7 to change the motor direction.

#### 2. Setting the Limits

2.1 Wake up the handset by pressing any button, apart from up or down.

2.2 Press the setup button in the back of the handset then the up button and then the setup button again (allow 1 second between pressing each button). The motor should beep and step each time you press a button. The motor should also step and beep 4 times to confirm the sequence is completed.

2.3 Make the blind go up. When the blind is near the upper limit press the setup button on the handset and the blind will step up slowly. Stop the blind in the desired upper limit position. Press stop 5 times, or until the blind steps. The motor should beep every time you press stop.

2.4 Make the blind go down. When the blind is near the lower limit press the setup button on the handset and the blind will step down slowly. Stop the blind in the desired lower limit position. Press stop 5 times, or until the blind steps. The motor should beep every time you press stop.

2.5 The limits have now been set. Test this by pushing the up and down buttons to make sure that the blind stops in the correct positions. [Please note that you must set both top and bottom limits before testing the limits.]

#### 3. Adjusting the Limits

3.1 To adjust the limits repeat the process for setting the limits.

#### 4. Cancelling the Limits

4.1 To cancel the limits press the setup button, down and then the setup button again (allow 1 second between pressing each button). You will now need to reset all the limits.

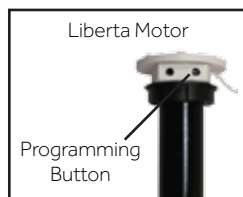
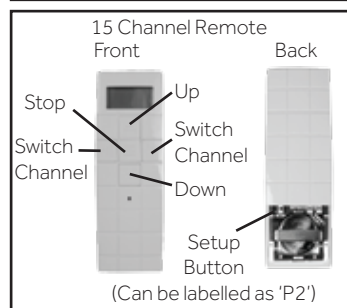
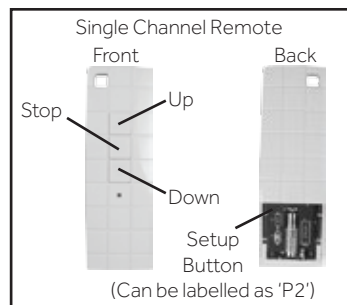

#### 5. Setting the 'Favourite Position'

5.1 Move the blind to the desired position. Press the setup button and then the stop button twice. The 'Favourite Position' has now been set. Press and hold the stop button to move to the 'Favourite Position'.

5.2 Reverse the progress to delete the 'Favourite Position'.

#### 6. Cancelling the Pairing & Limits

6.1 If all the limits and pairing need to be deleted then press the setup button, stop and then the setup button again. The handset will now need to be re-paired to the Motor.

#### 7. Reversing the Direction of a Motor

7.1 Press and hold the programming button on the motor for approximately 10 seconds. Release the button once the motor has stepped for the second time. The motor should beep twice.

#### 8. Adding an Additional Handset

8.1 Press the setup button twice on the original handset and then the setup button on the handset that is to be added (allow 1 second between pressing each button).

8.2 The motor should beep to confirm that the pairing has been successful.

#### 9. Extra Information

9.1 Approximate range of hand-held remotes with obstruction (such as a wall): 35m.

#### 10. Troubleshooting

Issue	Possible Cause	Solution
The blind is not responding to the remote	The blind has no power	Check the mains adaptor / batteries
	The blind is not paired to the remote	Follow steps 1 & 2
	The battery in the remote is flat	Replace the battery
	The incorrect channel is selected*	Select the correct channel
The blind is stopping in the incorrect position	The limits are set incorrectly	Reset the limits shown in stage 2
You press up but the blind goes down	The motor is running in the wrong direction	Change the direction of the motor (see section 6)
The blind is not pairing	The remote has channel 00 selected	Choose a different channel

\* 15 Channel remote only

#### 10. Further Support

10.1 Please contact your local distributor. Alternatively, you can scan the QR code and you'll find instruction videos on our website!

