

DECORQUIP[®]

Cura Roller Blind Motor

Fitting Instructions

This procedure can be completed by non-professionals.

Fitting the blind:

This procedure for fitting can be completed by non-professionals. No modification of the design or the configuration of the equipment must not be made without consulting with your local distributor.

1. Decide whether you want to fit face fix or top fix.
2. Position the brackets in where you want to fit the blind.
3. If necessary, mark through the brackets with a pencil, and drill and plug holes for the screws.
4. Fix the brackets with suitable fixings.. [Please note that screws and other fixings are not provided.]
5. Take the blind out of all the packaging and insert the pin into the round hole of the idle end bracket.
6. Hook the control end into the slotted bracket making sure that it is firmly clipped into place.
7. Remove the retaining strip of fabric holding the blind.

IMPORTANT SAFETY INSTRUCTIONS

WARNING - FOR PERSONAL SAFETY, IT IS IMPORTANT TO FOLLOW THESE INSTRUCTIONS AT ALL TIMES
SAVE THESE INSTRUCTIONS

Operating Instructions

1. Press the buttons on the remote to operate the blind. *15 Channel Remote Only* Switch channel using the buttons labelled on the inside page.
2. Do not allow children to play with the remote control of the blind. Keep remote controls away from children.
3. Take appropriate organisational measures for preventing operation of the blind when maintenance, such as window or wall cleaning, is being carried out in the vicinity.

Maintenance Instructions

1. Replacing/Recharging the Batteries (Cura Motor with Battery Option only)

- 1.1 Unplug the wire from the motor
- 1.2 Remove the battery tube from the brackets.
- 1.3 Unscrew the end of the battery tube and remove and replace the batteries. Ensure that the polarity of the batteries is correct, and that the end cap of the battery tube is screwed back on tightly.
- 1.4 Clip the battery tube back into the brackets.
- 1.5 Please note that if you are using rechargeable batteries, you can plug Power Adaptor code 191662 into the female part of the wire coming from the battery tube. Leave the Power Adaptor for 6 hours to recharge the batteries.

2. Caring for your Blind

- 2.1 Wiping the blind with a soft brush or duster is usually sufficient.
- 2.2 If necessary, Blinds can be wiped clean with a mild detergent and warm water. Leave in the open position to dry.
- 2.3 Do not make alterations to the blind, motor or handset.
- 2.4 Frequently examine the installation for signs of wear or damage to cables. Do not use if a repair is necessary.
- 2.5 For an inspection or maintenance of the electrical parts, the internal blind shall be disconnected from the energy supply in a safe way.

The sound level emitted by the blind is less than or equal to 70 dB(A).

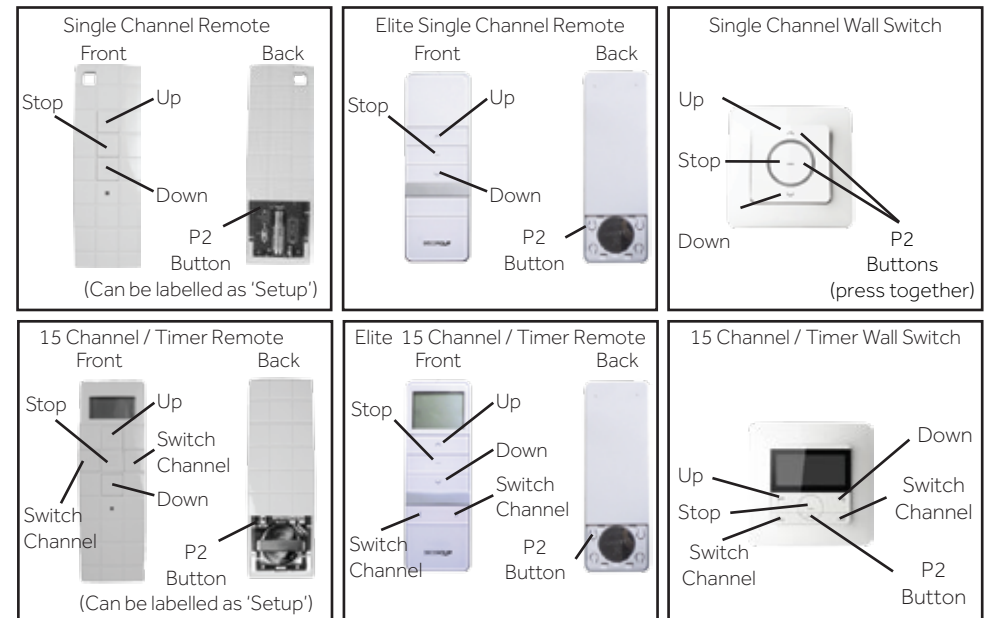

Cura Roller Blind Motor

Programming Instructions

1. Pairing the Handset

1.1 *15 Channel Handset Only *Select the channel on the handset that you wish to pair the blind to. [Please note that you cannot pair blinds to Channel 00.]

1.2 Press and hold the programming button on the motor. Alternatively, if the motor is not easily accessible and you are using a power adapter, you can turn the power to the motor off and back on again. The motor should step and beep.

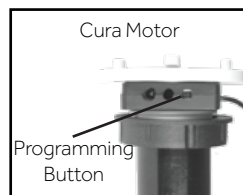

1.3 Press the P2 button (labelled as Setup or P2) on the back of the handset twice then the up button. This must be done in a smooth rhythm (allow 1 second between pressing each button). The motor should beep and step to confirm that the pairing is complete.

1.4 Check that the motor is running in the correct direction. (I.e. Press the up button and the blind goes up). If required, refer to section 7 to change the motor direction.

1.5 All blinds paired to a handset will all automatically work together when you select channel 00.

2. Setting the Limits

2.1 Wake up the handset by pressing any button, apart from up or down.

2.2 Press the P2 button in the back of the handset then the up button and then the P2 button again (allow 1 second between pressing each button). The motor should beep and step.

2.3 Make the blind go up. When the blind is near the upper limit press the P2 button on the handset and the blind will step up slowly. Stop the blind in the desired upper limit position. Press stop 5 times, or until the blind steps. The motor should beep every time you press stop.

2.4 Make the blind go down. When the blind is near the lower limit press the P2 button on the handset and the blind will step down slowly. Stop the blind in the desired lower limit position. Press stop 5 times, or until the blind steps. The motor should beep every time you press stop.

2.5 The limits have now been set. Test this by pushing the up and down buttons to make sure that the blind stops in the correct positions. [Please note that you must set both top and bottom limits before testing the limits.]

3. Adjusting the Limits

3.1 To adjust the limits repeat the process for setting the limits.

4. Cancelling the Limits

4.1 To cancel the limits press the P2 button, down and then the P2 button again (allow 1 second between pressing each button). You will now need to reset all the limits.

6. Cancelling the Pairing & Limits

6.1 If all the limits and pairing need to be deleted then press the P2 button, stop and then the P2 button again. The handset will now need to be re-paired to the Motor.

7. Reversing the Direction of a Motor

7.1 Press and hold the programming button on the motor until the blind steps. The direction of the motor should be reversed.

8. Adding an Additional Handset

8.1 Press the P2 button twice on the original handset and then the P2 button on the handset that is to be added (allow 1 second between pressing each button).

8.2 The motor should beep to confirm that the pairing has been successful.

9. Extra Information

9.1 Approximate range of hand-held remotes with obstruction (such as a wall): 35m.

9.2 If you are adding more than one blind to a channel, ensure that all other blinds paired to that channel have the power turned off. Once the other blind has been paired and had the limits set the other blinds can be turned back on.

10. Troubleshooting

Issue	Possible Cause	Solution
The blind is not responding to the remote	The blind has no power	Check the power / batteries
	The blind is not paired to the remote	Follow steps 1 & 2
	The battery in the remote is flat	Replace the battery
	The incorrect channel is selected*	Select the correct channel
The blind is stopping in the incorrect position	The limits are set incorrectly	Reset the limits shown in stage 2
You press up but the blind goes down	The motor is running in the wrong direction	Change the direction of the motor (see section 6)
The blind is not pairing	The remote has channel 00 selected	Choose a different channel

* Multi-channel remotes only

10. Further Support

10.1 Please contact your local distributor.